

# GLUGGAR OG HURÐIR M.K. 1/25

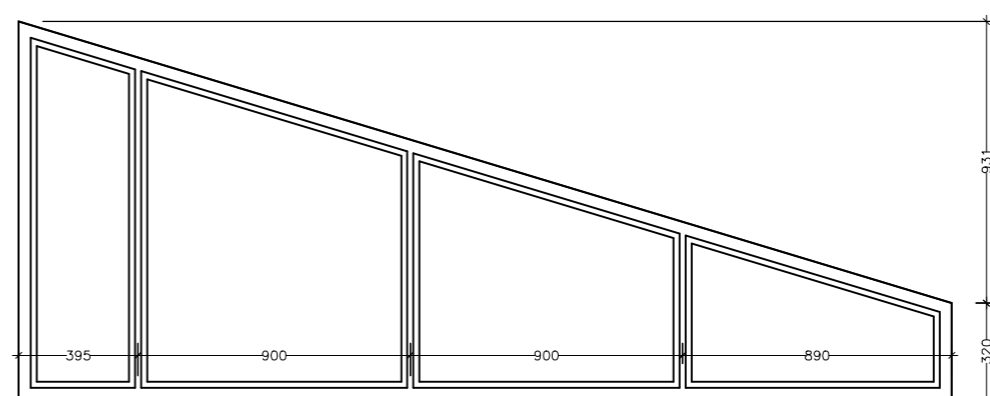

**G6** 1 stk. (gafi)

fl.mál: 2,42 m<sup>2</sup>  
ummál: 7,88 m

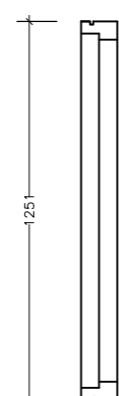
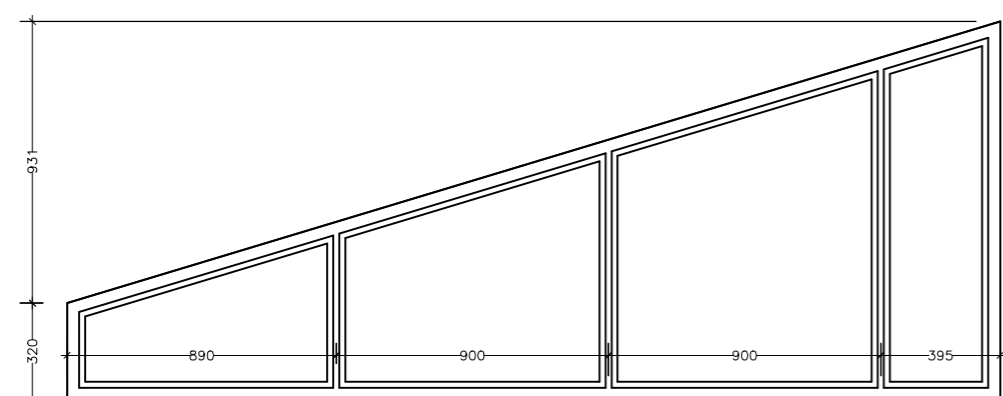
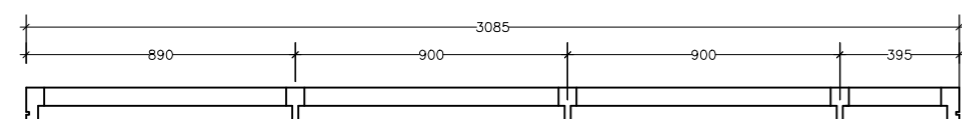

**G7** 1 stk. (gafi)

fl.mál: 2,42 m<sup>2</sup>  
ummál: 7,88 m

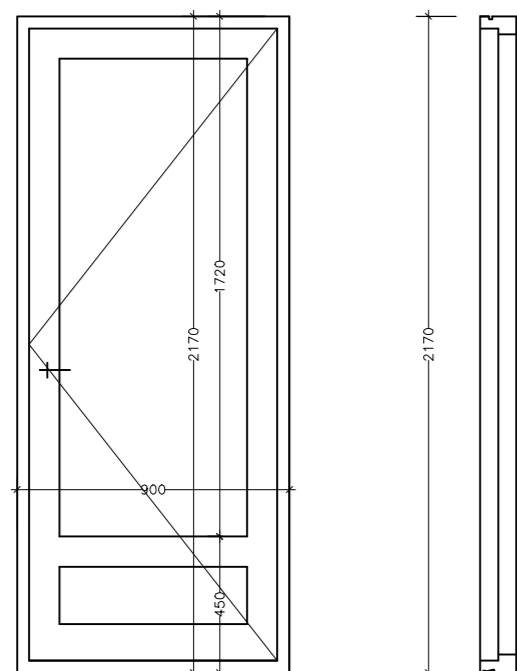
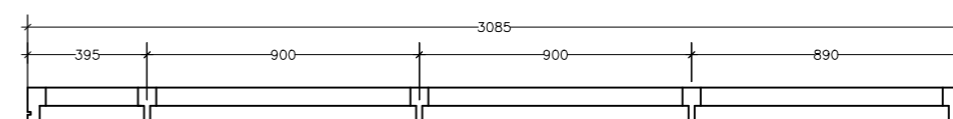

**H1** 1 stk.

fl.mál: 1,95 m<sup>2</sup>  
ummál: 6,14 m

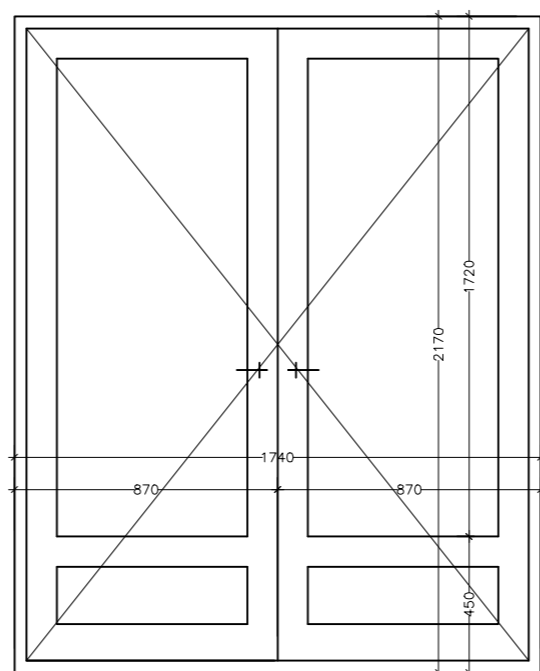
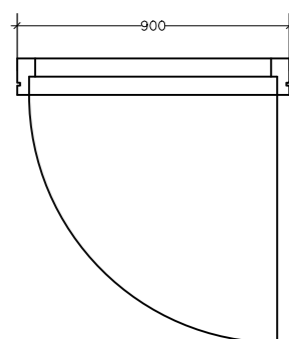

**H2** 1 stk.

fl.mál: 3,78 m<sup>2</sup>  
ummál: 7,82 m

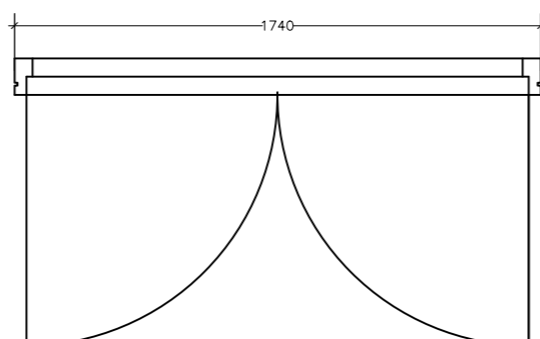

## SKÝRINGAR

Gluggar skulu vera af viðurkenndri gerð. Gluggaframleiðandi skal uppfylla styrkleikakröfur og kröfur um hámarkssvignun gluggapósta.

Gler skal vera háeinangrandi K-gler.